

HS400

Flat & Angled Stand
DMD100, DMD101

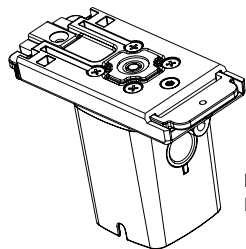

Flat Stand
DMD100

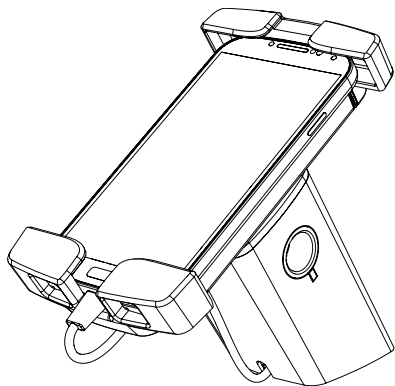
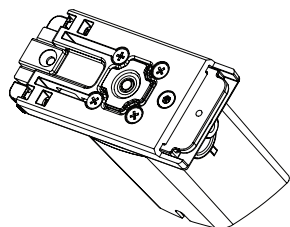

Angled Stand
DMD101

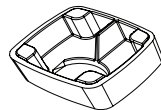

Angled Stand Adapter
Must use with 10" and 12" tablets only.

- 1 Drill a 25.4 mm (1") hole in fixture. Wipe fixture with alcohol wipe provided. **Let it dry completely.**

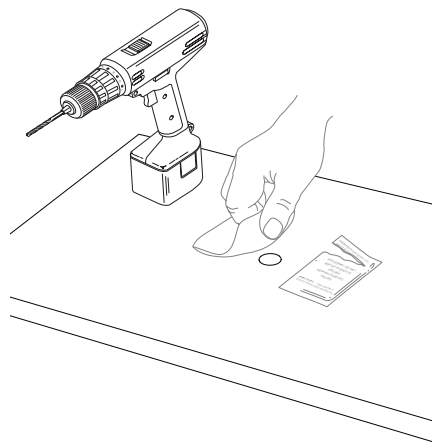

- 2 Remove clear film off adhesive on bottom of base. Slide base through fixture with "front" facing front of fixture. Press firmly for 10 seconds.

Note: For 10" and 12" tablets, skip this step and continue to step 3 and 4.

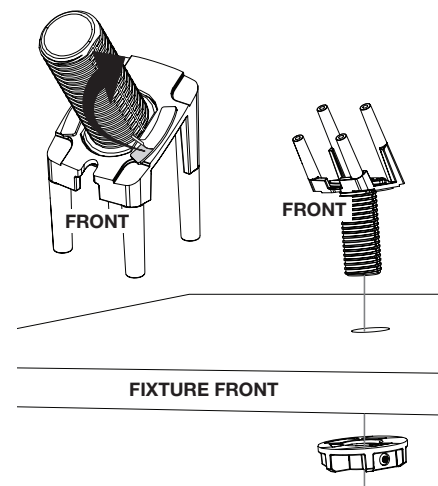

- 3 **For 10" and 12" tablets only:** Slide adapter onto base. Do not remove clear film from adhesive on bottom of base.

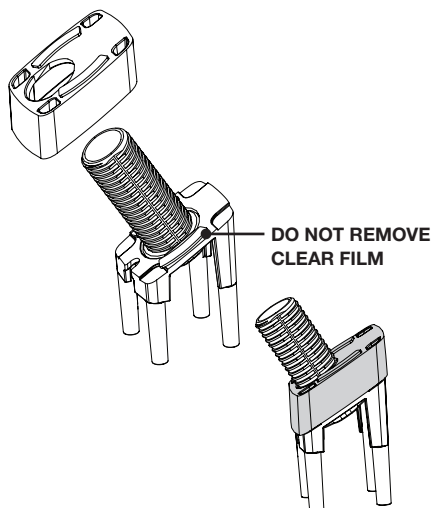

- 4 **For 10" and 12" tablets only:** Remove clear film off adhesive on bottom of adapter. Slide base and adapter through fixture with "front" facing front of fixture. Press firmly for 10 seconds.

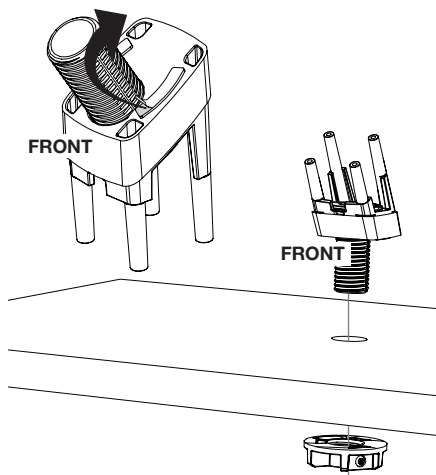

- 5 Tighten nut below fixture. **Optional:** Tighten at least 1 screw in nut with T-20 bit.

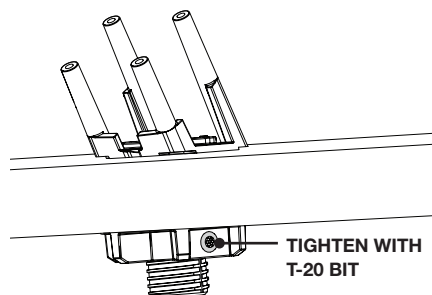

- 6 Slide OEM power cord through fixture first then slide alarm cord through fixture and attach stand to base. Confirm IR lens is on right hand side.

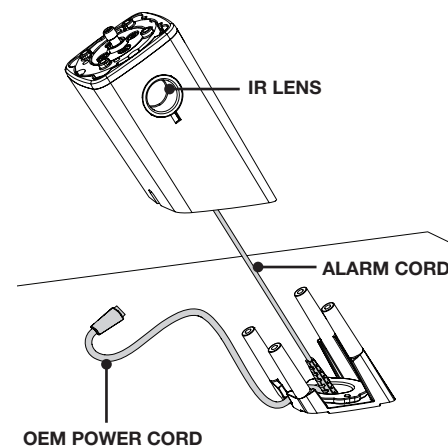

- 7** **APPLY FORCE** to rotate dial 45 degrees clockwise to gain access to screws. Tighten all 4 screws onto stand.

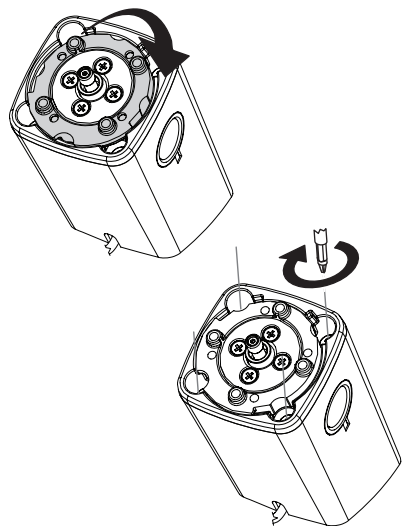

- 8** Rotate dial back counter clockwise until it hits against stop.

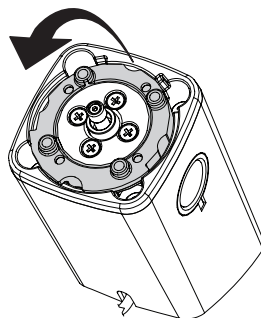

- 9** Attach plate to stand and place spring loaded end to left.

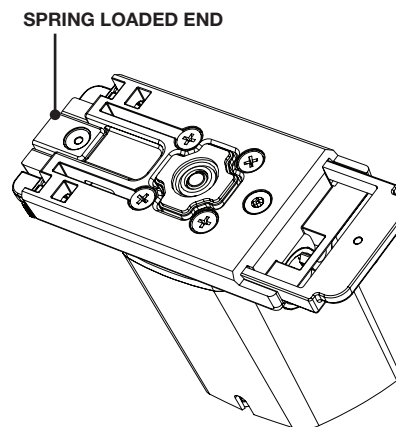

- 10** Tighten all 4 screws on plate.

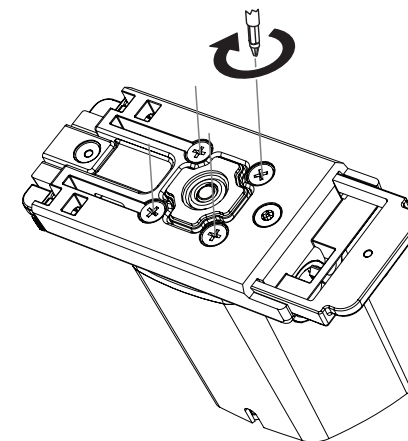

- 11** 1) Attach quick release bracket on spring loaded end and tighten screw.
2) Attach adjustable bracket onto plate and tighten screw.

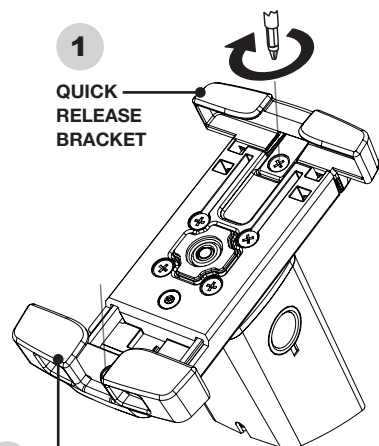

- 2** **ADJUSTABLE BRACKET**

- 12** If quick release bracket is closed with no merchandise and stand is plugged into alarm unit or alarming only box (see step 19), alarm will go off. Use IR2 key to turn off alarm.

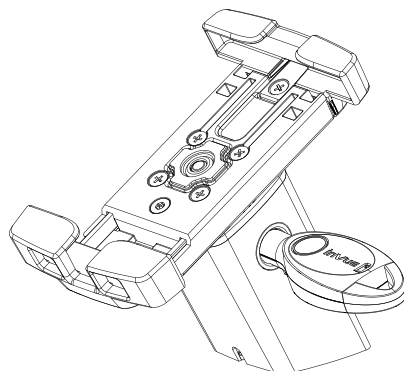

- 13** Confirm adjustment screw is slightly loose and quick release bracket is fully open and extended. Use IR2 key to open bracket if closed. Hold IR2 key on IR lens until you hear a "beep."

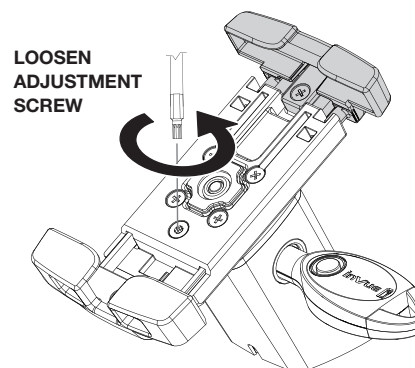

- 14** Place merchandise into bracket and move adjustable bracket so top of merchandise aligns with bottom edge of quick release bracket.

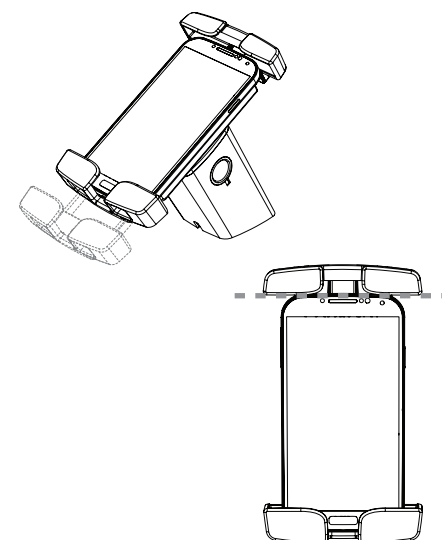

15

Hold adjustable bracket in place and remove merchandise. Tighten adjustment screw with T-20 bit.

FULLY
TIGHTEN
ADJUSTMENT
SCREW

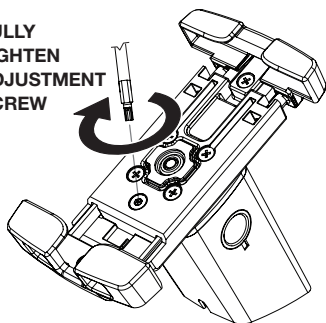

16

Remove clear film off medallion. Place merchandise into adjustable bracket and press down on merchandise to adhere medallion onto back of merchandise.

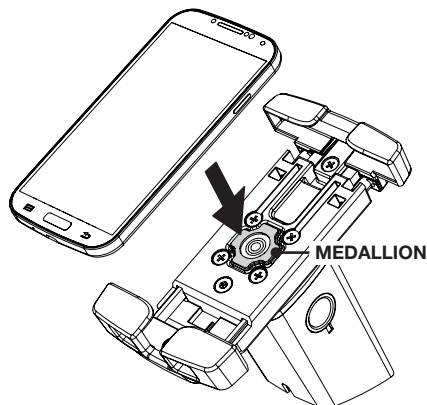

17

Remove merchandise from bracket and press down on medallion to ensure it is fully attached to back of merchandise.

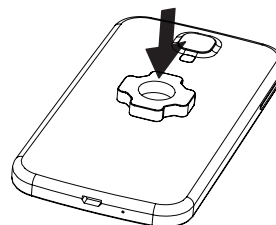

18

Place merchandise back into bracket and press down on quick release bracket to lock merchandise into stand. Plug OEM power cord into merchandise and tuck cord on hook under bracket.

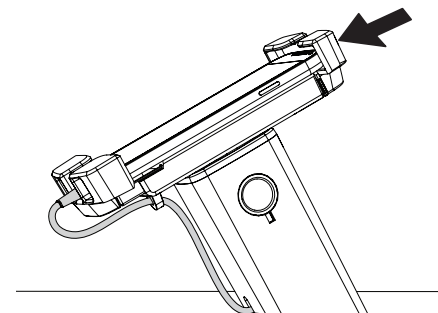

19

If alarming display: Plug alarm cord into Zips! 2.0 alarm unit or Series 2800 alarming only box.

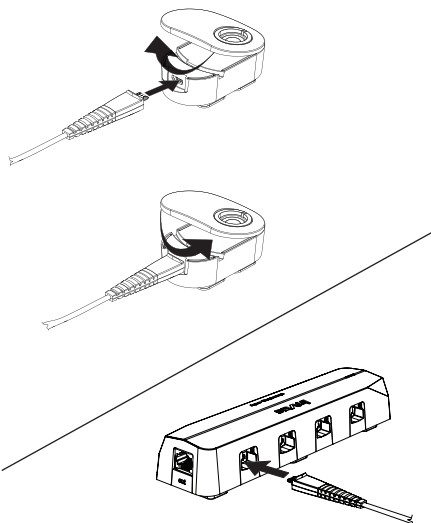

20

To remove merchandise from bracket: Place IR2 key on IR lens on stand and press button on key once. Hold key on IR lens until you hear a "beep." Quick release bracket will open. Unplug OEM cord and remove merchandise.

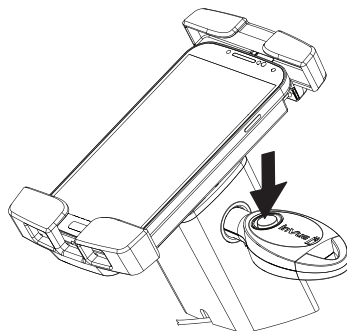

SD0254 Rev4 07/13/15

inVue
tough security made easy

www.invuesecurity.com

NA / LATAM // 704.752.6513 • 888.55.INVUE

EMEA // +31.23.8900150

APAC // +852.3127.6811

© 2015 InVue Security Products Inc. All rights reserved.
InVue is a registered trademark of InVue Security Products.