

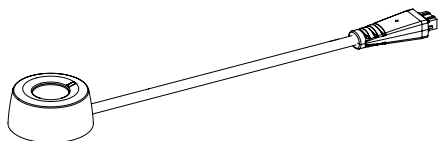

**Zips Power Multiport  
Remote IR Dot**  
ZP4001-W, ZP4001-B



**1**

Above Counter: Route cable through hole (15mm minimum) or access area in fixture for mounting on fixture surface. Plug

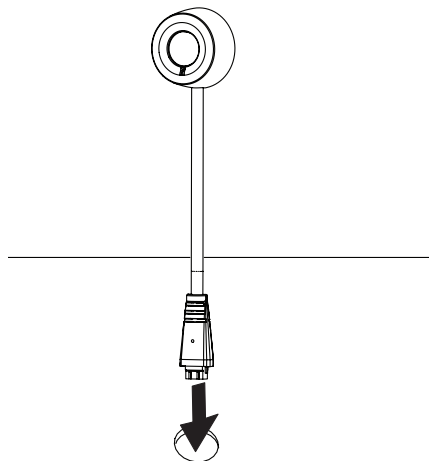

**2**

Wipe surface and merchandise with alcohol wipe. **Let dry completely.**

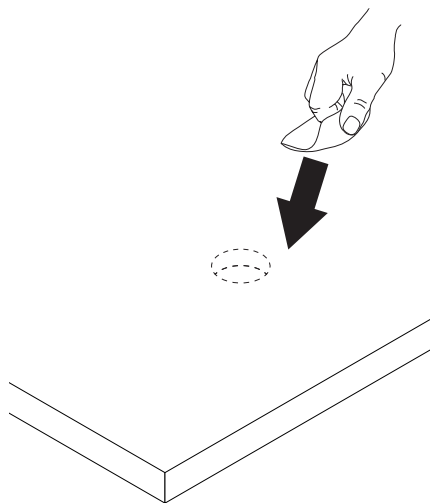

**3**

Remove clear film from the adhesive. Place IR dot in the desired location and press down for at least 10 seconds.

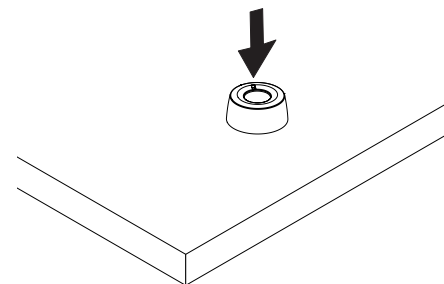
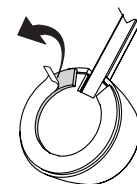

**4**

Below counter: Plug IR Dot cord into Alarm Unit. IR Dot LED will light.

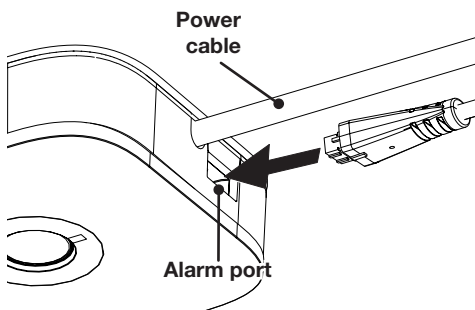

**Note:** When using the remote IR dot, the IR dot on the alarm unit is deactivated.

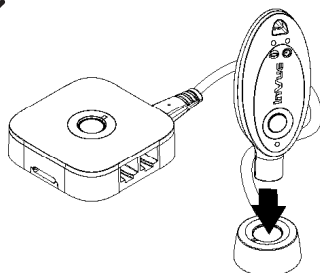
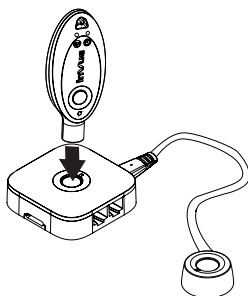

SD0417 Rev5 03/07/17

**inVue**

[www.invue.com](http://www.invue.com)

NA / LATAM // 704.752.6513 • 888.55.INVUE

EMEA // +31.23.8900150

APAC // +852.3127.6811

© 2017 InVue Security Products Inc. All rights reserved.  
InVue is a registered trademark of InVue Security Products.