

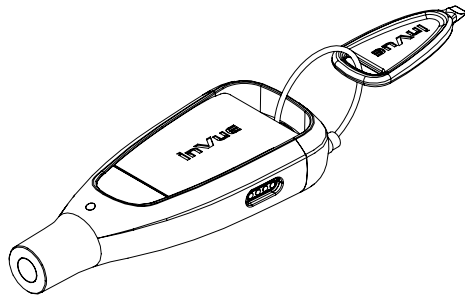

## OneKEY

IR4 BLE OneKEY



**Note:** See the instructions included with the OneKEY Manager & Charger for full installation information of those components.

- 1a** Remove the OneKEY from its packaging and place the Key onto the contacts of a previously installed OneKEY charger. Allow the Key to charge for 6 hours before use.

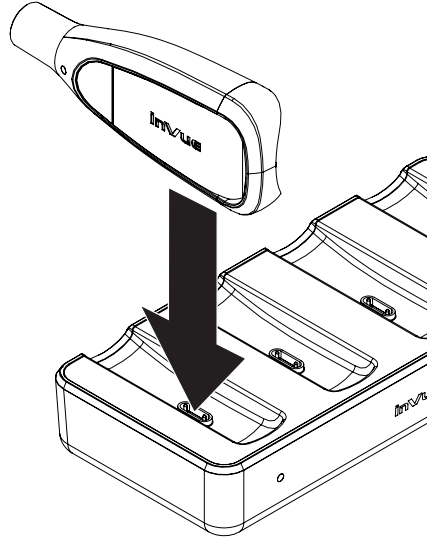

- 1b** If using the Single Key Charger (OK4101), slide the OneKEY into the charger. Ensure that the charging contacts on the OneKEY align with the charging contacts on the charger.

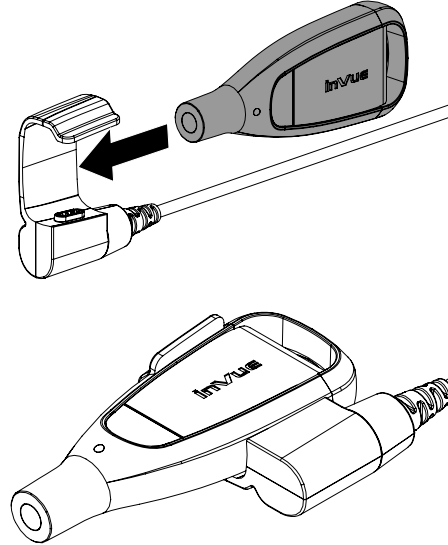

Below is a breakdown of the IR4 Key's LED indicators.

- Green - Battery and Timeout are good for continued use.
- Yellow - Return the Key to the Manager within the hour. Battery is low or Timeout is close to expiration.
- Red - Return the Key to the Manager immediately. Battery is too low for continued use or the Key has timed out.
- No LED - Return the Key to the Charger immediately. Battery is completely depleted.

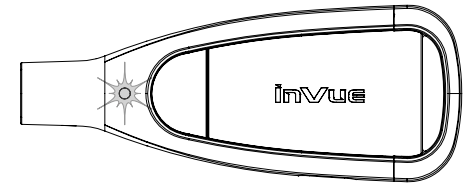

- 2** Once charged, remove a OneKEY from the charger (multi or single).

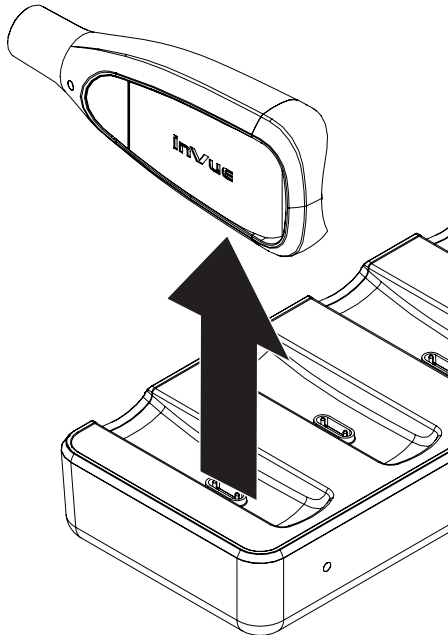

- 3** For first time usage, place the Key onto the contacts on the OKM.

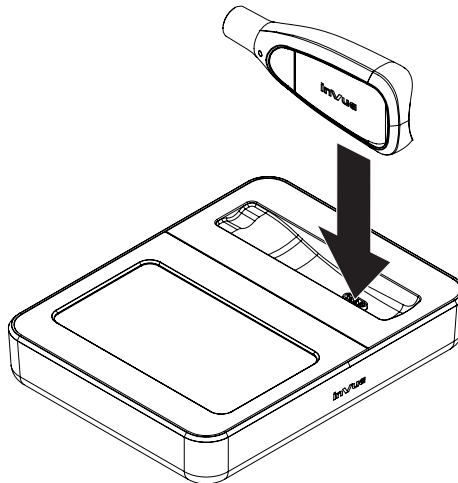

- 4** Ensure that this screen is displayed on the OKM.



- 5** The Key will sync with the OKM.

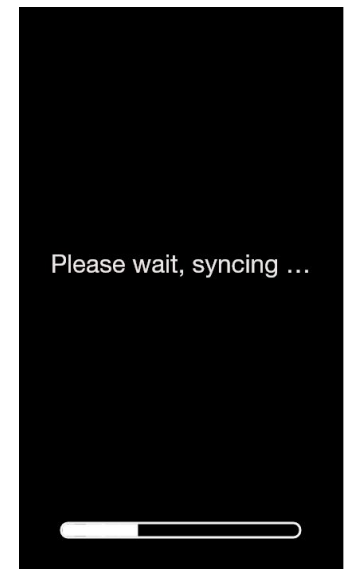

6

## Field Usage

Once the Key has been initially entered into the LIVE Access environment and the Key is being used in the field, press and hold the button on the Key for 3 seconds, the LED will flash blue as it broadcasts.

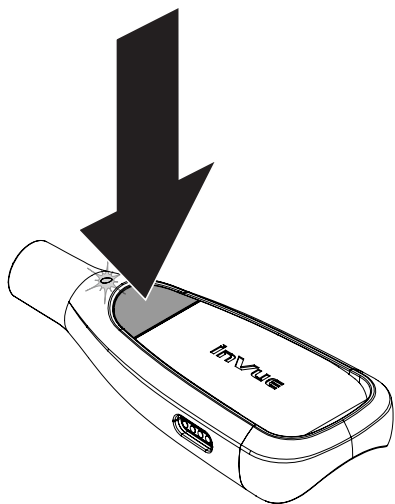

7

With the LIVE Access app open on your device, look for the Key's serial number. Select the Key.

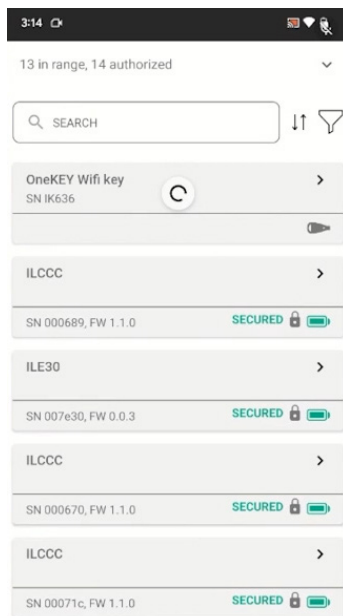

8

Select "CHECK OUT".

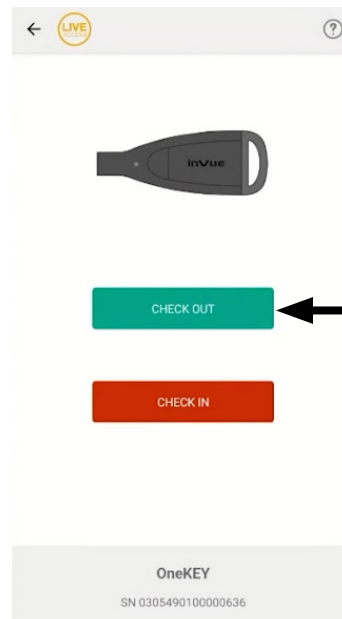

9

The Key will chirp in confirmation, the LED will flash green and app will show that the Key has been checked out and can now be used.

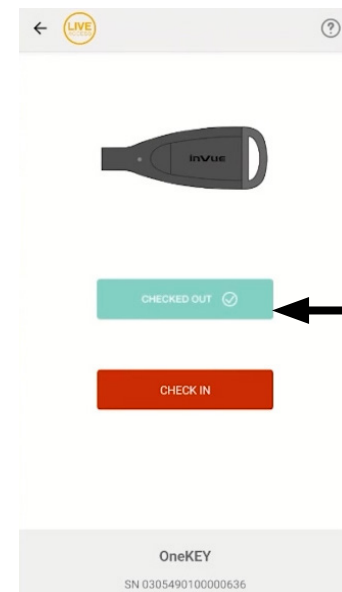

10

## Deactivating/Checking in a Key

When the Key is ready to be checked back in/deactivated, press and hold the button on the Key for 3 seconds, the LED will flash blue as it broadcasts.

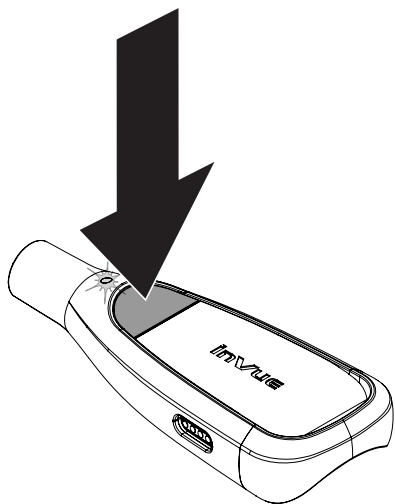

11

With the LIVE Access app open on your device, look for the Key's serial number. Select the Key.

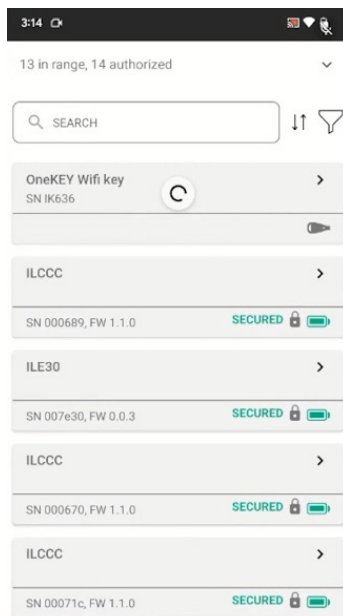

12

When the Key is ready to be checked back in (such as the end of a shift), select the "CHECK IN" button in the app.

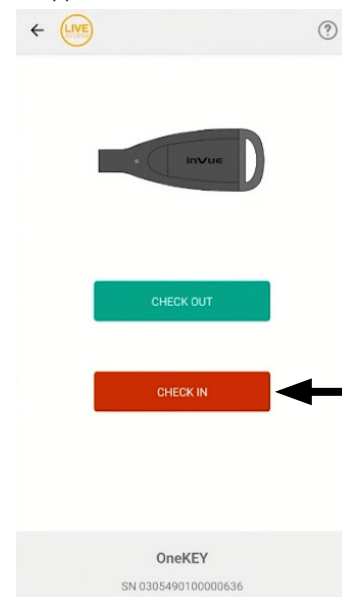

13

After a few moments the app will show that the Key has been checked back in and has been deactivated.



14

Return the Key to the charger (single or multi).

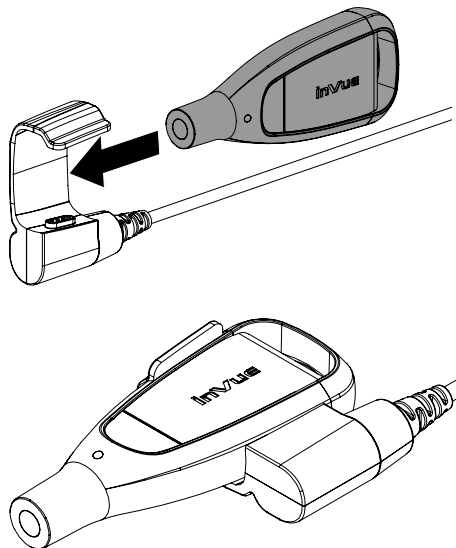

### Battery Warnings:

- The Key & OneKEY Manager contain non-replaceable lithium ion batteries.
- The entire device should be recycled at an approved center for rechargeable batteries.
- Do not immerse in water.
- Do not place in a fire or excessive heat.
- Do not disassemble, puncture or pierce.

SD0906 Rev0 03/20/22

# inVue®

[www.invue.com](http://www.invue.com)

NA / LATAM // 704.752.6513 • 888.55.INVUE

EMEA // +31.23.8900150

APAC // +852.3127.6811