

LIVE Cam Lock LL301



- 1 Optional:**
For ease of installation, use an Installer Key (if you have one) to unlock the lock. If using the Installer Key in a lock with the battery tabs in place, it will pause the lock in an unlocked state.



- 2** Determine the lock mounting orientation.



- 3** Use the provided alcohol wipe to clean the area where the lock body will be mounted. Allow it to dry completely.



- 4** Place the shaft adapter over the shaft on the lock body. Ensure that it is correctly oriented to fit into the hole in the fixture.



- 5** Insert and tighten the 2 small screws to secure the shaft adapter.

LIVE Cam Lock LL301



6 Peel the clear liners from the 2 adhesives on the lock body.



7 Insert the shaft through the hole in the drawer. Press the lock body against the surface for at least 10 seconds.

8 Place the lock washer over the shaft.



9 Thread the nut onto the shaft.



10 Use a wrench to tighten the nut.

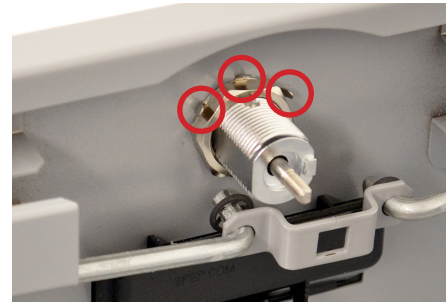

11 Bend the prongs on the lock washer over the nut to prevent it from loosening.

LIVE Cam Lock LL301

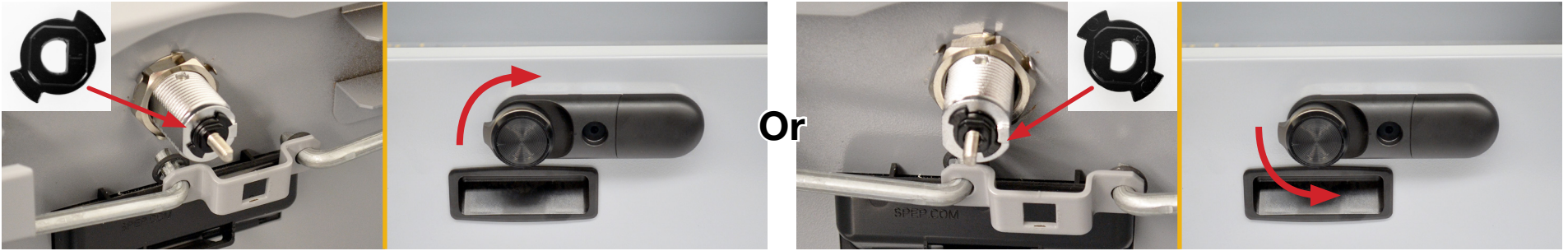

- 12 Place the cam arm interface adapter onto the shaft to determine the direction the turn of the handle. Flip the cam arm interface adapter over (as shown above) to toggle between left and right hand rotation to open.



- 13 Place the original hardware back onto the shaft.
Note: This applies to both double-throw locks and single cam arms.



- 14 Thread the supplied nut onto the shaft.



- 15 Use a wrench to fully tighten.



- 16 Pull the battery tabs.



17a Lock Activation Using OneKEY: Place a charged and coded OneKEY against the lens on the lock and press the button the Key. The LED on the Key and the lock will flash green.



17b You will have several seconds to turn the knob to unlock and open. If the LED on the lock flashes red before the lock is opened, it will need to be unlocked again.



18a Lock Activation Using NFC: Open the InVue LIVE Access App on your smart device. Tap your device against the round panel on the lock. Once confirmed by the App displaying "unlocked" and the LED flashing green.



18b You will have several seconds to turn the knob to unlock and open. If the LED on the lock flashes red before the lock is opened, it will need to be unlocked again.



19a Using the 2D Barcode: Insert a thin edged tool into the small notch between the lock body and the round plate.



19b Remove the panel to reveal the barcode.



20a Lock Activation Using Scanning Device: If your smart device has a built in barcode reader, aim and scan the code on the front of the lock while the InVue LIVE Access App is open. Once confirmed by the App displaying "unlocked" and the LED flashing.



20b You will have several seconds to turn the knob to unlock and open. If the LED on the lock flashes red before the lock is opened, it will need to be unlocked again.



21a Lock Activation Using Device Camera: Open the InVue LIVE Access App on your smart device and toggle to the “Camera Scan” screen. Center the barcode in the viewfinder. Once confirmed by the App displaying “unlocked” and the LED flashing green.



21b You will have several seconds to turn the knob to unlock and open. If the LED on the lock flashes red before the lock is opened, it will need to be unlocked again.



22 Battery Replacement Steps: Place a magnet key near the end of the battery panel on the lock. **Note:** Even with low batteries the lock will still function with a OneKEY.



23 Remove the battery panel from the lock.



24 Replace the old batteries with new CR123A non-rechargeable lithium batteries.



25 Slide the battery panel back into place.



Warning – Fire, Explosion, Burn Hazard:

InVue recommends the use of Great Power or Energizer CR123A batteries. Use of other batteries, mixing of used and new or different battery chemistries may present a risk of leakage, fire, explosion and serious personal injury. Do not ingest, recharge, misuse, short circuit, improperly store or discard, disassemble or heat above 212°F (100°C). Keep away from children.